



reddot winner 2020
best of the best



reddot winner 2020
best innovative product

INSTALLATION INSTRUCTIONS 2025

Be smart.



ASSEMBLY OF THE END PROFILES



The width of the connection joint should be between 6 and 13 mm depending on the used profile system. The thickness of the flooring must also be taken into account. Our type X5 systems can be used with a minimum floor covering thickness of 5 mm.

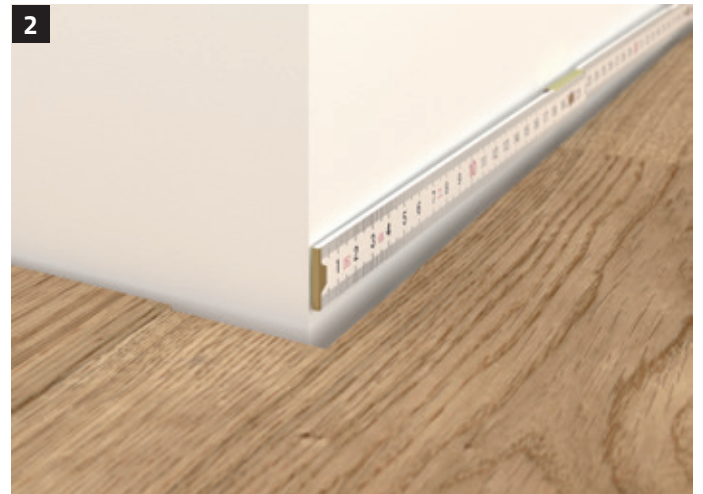

The dimensions for the profile cuts are taken from the wall surfaces. Miter cuts for inside and outside corners are taken into account.

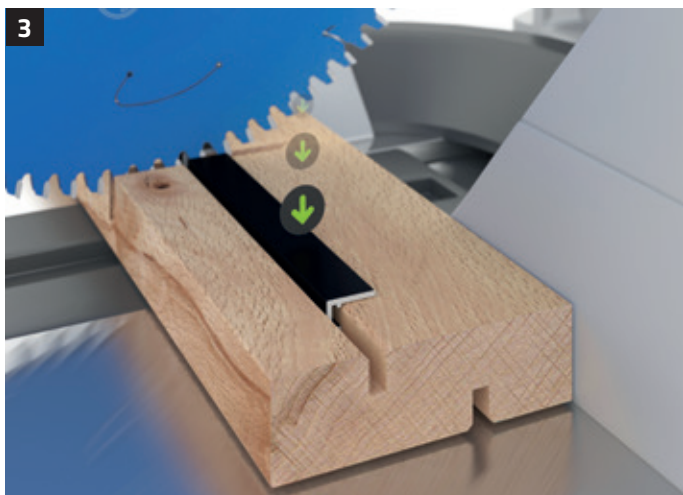

The profiles are cut to length. The miter cut for inside or outside corners is made in one step. The profile is securely positioned in our cutting aid. This prevents the profile from jamming during the cutting process.



The mounting clips are pushed into the profile on the front. Attention: Two opposite shoulders are worked into the profile, between which the mounting clips are easily guided.

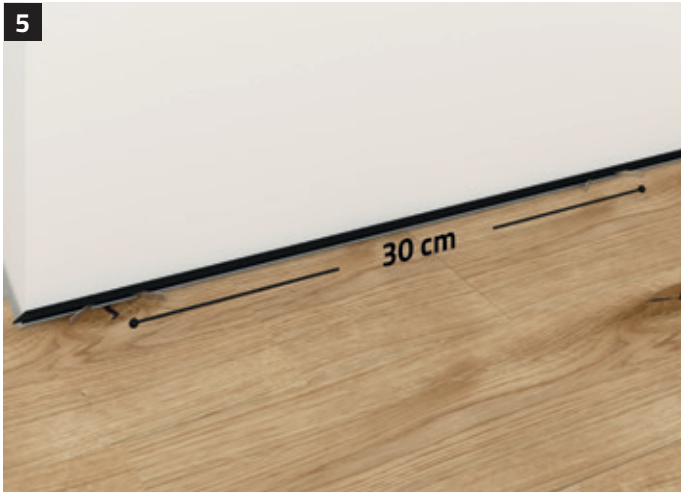

Insert mounting clips every 30 cm in the end strip.

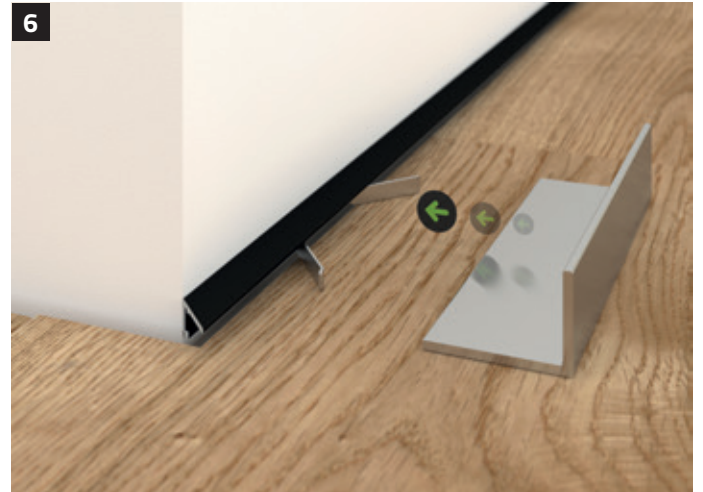

The end profile with the inserted mounting clips is now brought into the mounting position on the wall surface. With the assembly aid, the assembly clips are carefully spread out by using the assembly aid to apply the assembly clips towards the wall.



As soon as the clamping process is completed, the end profile is pressed down and the assembly aid is removed. Now the tensioning and assembly process is repeated until all assembly clips on an end profile are tensioned and countersunk. For any corrections the end profile can be removed from the connection joint at any time.

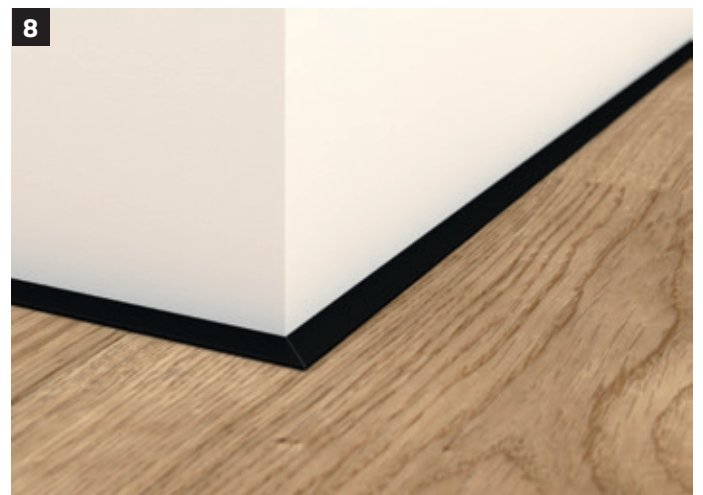

The end profile is installed. After a brief inspection, the next section can be assembled.

ASSEMBLY OF THE TRANSITION PROFILES

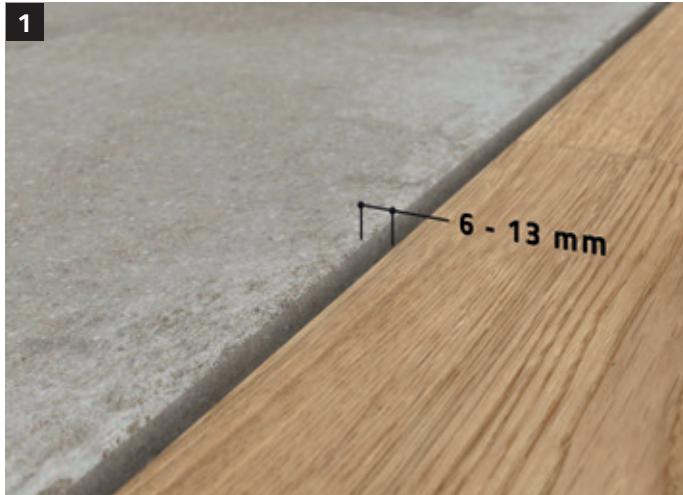

The width of the connection joint should be between 6 and 13 mm. The thickness of the flooring must also be taken into account. Our type X5 systems can be used with a minimum floor covering thickness of 5 mm.



The dimensions for the profile cuts are taken from the floor covering. Any mitre cuts are taken into account.

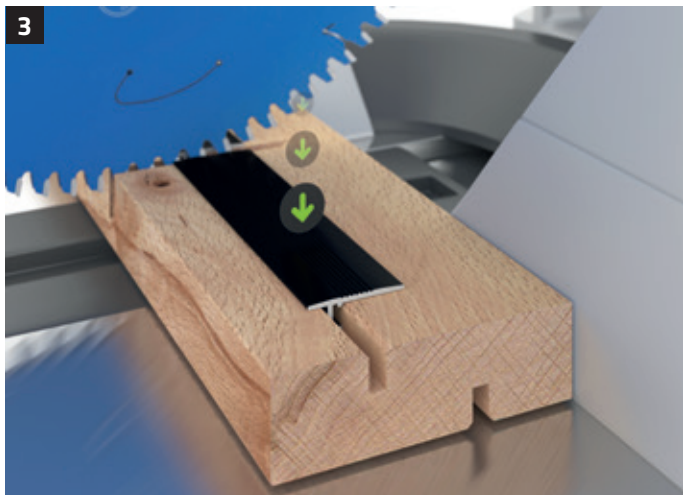

The profiles are cut to length. The profile is securely positioned in our cutting aid. This prevents the profile from jamming during the cutting process.



The mounting clips are pushed into the transition profile on the front. Attention: Two opposite shoulders are worked into the transition profile, between which the mounting clips are easily guided.

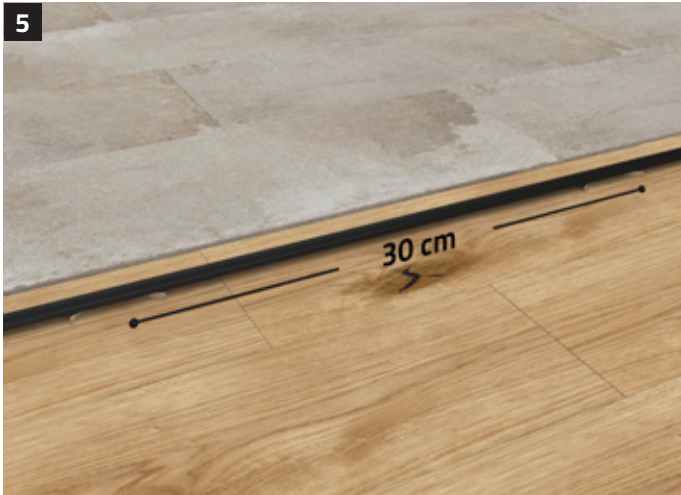

Insert mounting clips every 30 cm in the end strip.

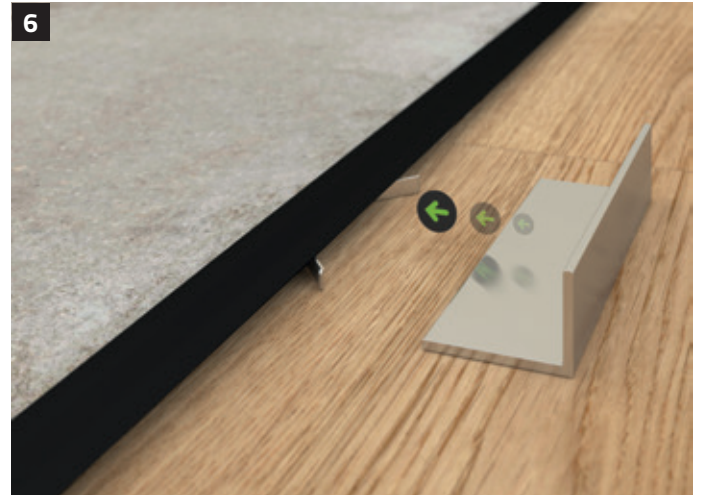

The transition profile with the inserted mounting clips is now brought into the mounting position on the transition joint. With the assembly aid, the assembly clips are carefully spread out by using the assembly aid to apply the assembly clips towards the transition profile.

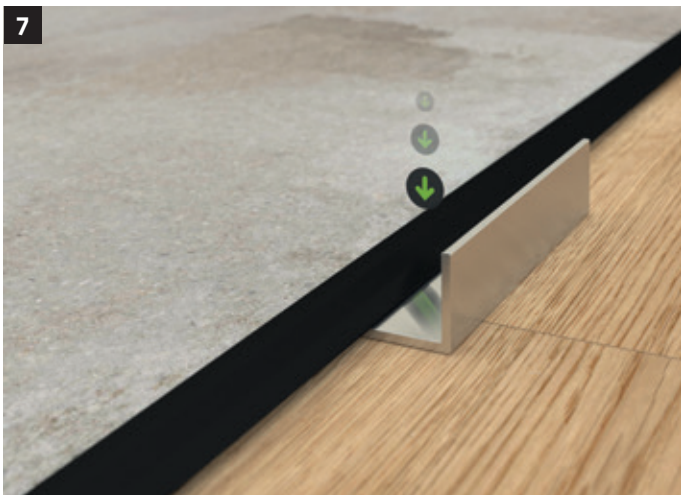

As soon as the clamping process is completed, the end profile is pressed down and the assembly aid is removed. Now the tensioning and assembly process is repeated until all assembly clips on an transition profile are tensioned and countersunk. For any corrections the transition profile can be removed from the connection joint at any time.



The transition profile is installed. After a brief inspection, the next section can be assembled.

ASSEMBLY OF THE END PROFILES ADHESIVE VINYL

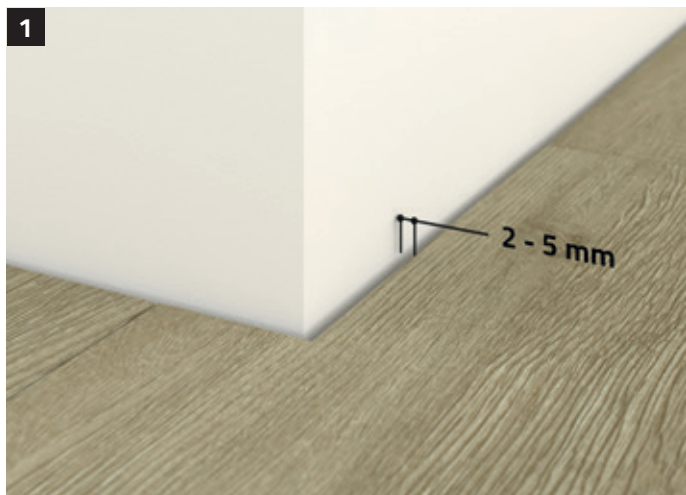

The width of the connection joint should be between 2 and 5 mm. The thickness of the flooring must also be taken into account. Our type X2 systems can be used with a minimum floor covering thickness of 2 mm up to 5 mm.



The dimensions for the profile cuts are taken from the wall surfaces. Miter cuts for inside and outside corners are taken into account.

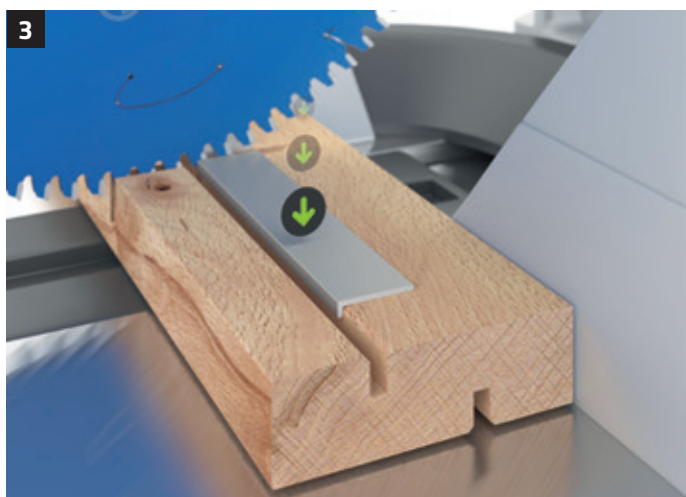

The profiles are cut to length. The miter cut for inside or outside corners is made in one step. The profile is securely positioned in our cutting aid. This prevents the profile from jamming during the cutting process.



The individual profiles are „tried on“ **WITHOUT** adhesive **BEFORE** installation. If everything fits, the profiles are removed again and gluing begins.



The individual adhesive strips are pulled off from the adhesive sheet (observe the pull-off tab) and glued to the floor covering flush with the edge of the connection joint on the long side. **The floor covering must be dry and free of dust or grease. Clean before installation if necessary. Ideal installation temperature from +15°C to +30°C.**

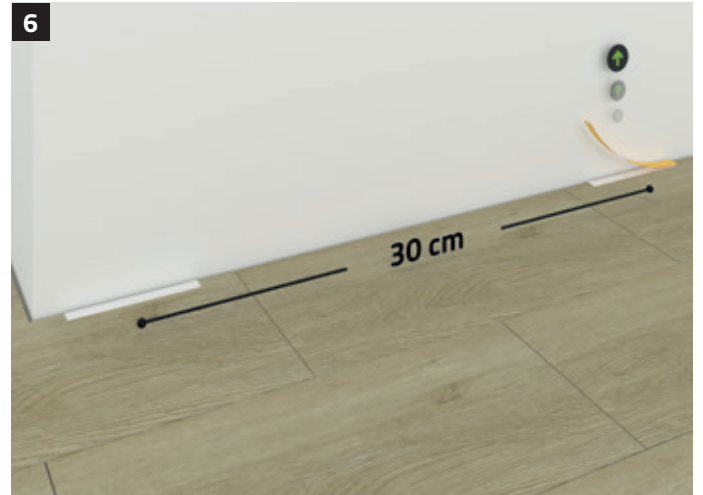

Now the end profile can be guided along the wall and simply glued onto the adhesive strips. Correct positioning is important because after the first adhesive strip, the skirting board can no longer be moved parallel to the wall.



Stick the adhesive strips onto the floor covering every 30 cm according to point 5. Before installing the end profiles, pull the yellow wax foil of the adhesive strips upwards at the tab.



The end profile is installed. After a brief inspection, the next section can be assembled.

ASSEMBLY OF THE TRANSITION PROFILES ADHESIVE VINYL

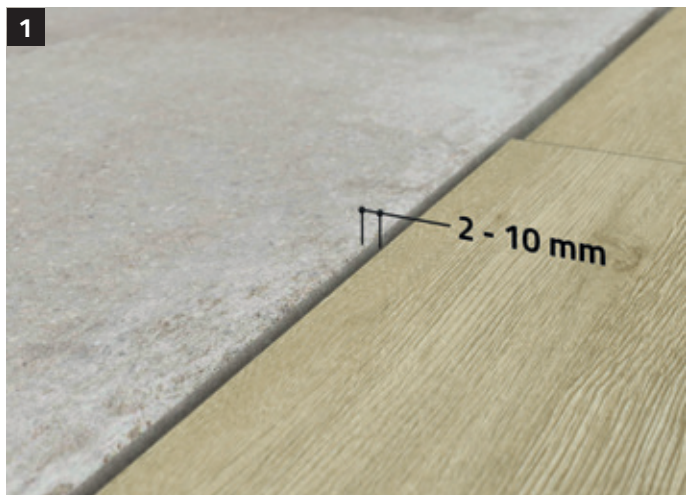

The width of the connection joint should be between 2 and 10 mm. The thickness of the flooring must also be taken into account. Our type X2 systems can be used with a minimum floor covering thickness of 2 mm.



The dimensions for the profile cuts are taken from the floor covering. Any mitre cuts are taken into account.

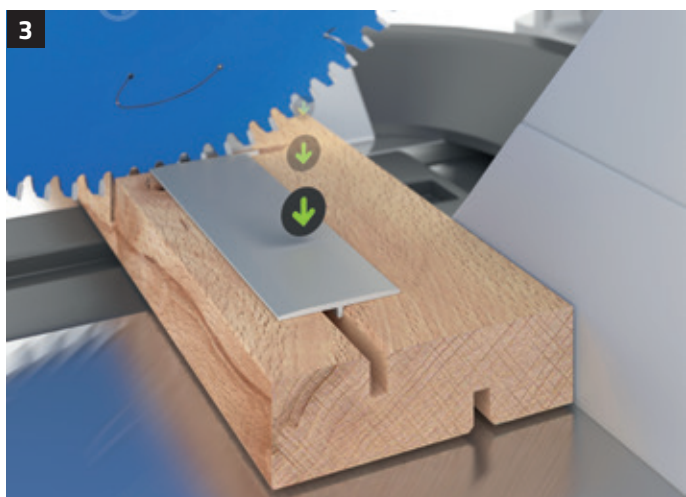

The profiles are cut to length. The profile is securely positioned in our cutting aid. This prevents the profile from jamming during the cutting process.



The individual profiles are „tried on“ **WITHOUT** adhesive **BEFORE** installation. If everything fits, the profiles are removed again and gluing begins.



The individual adhesive strips are pulled off from the adhesive sheet (observe the pull-off tab) and glued to the floor covering flush with the edge of the connection joint on the long side. **The floor covering must be dry and free of dust or grease. Clean before installation if necessary. Ideal installation temperature from +15°C to +30°C.**

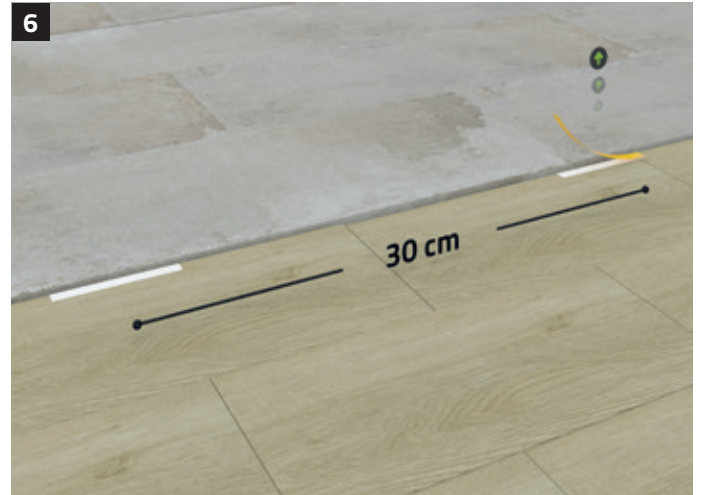

Now the transition profile can simply be glued onto the adhesive strips. Correct positioning is important because after the first adhesive strip the skirting board can no longer be moved parallel to the transition joint.

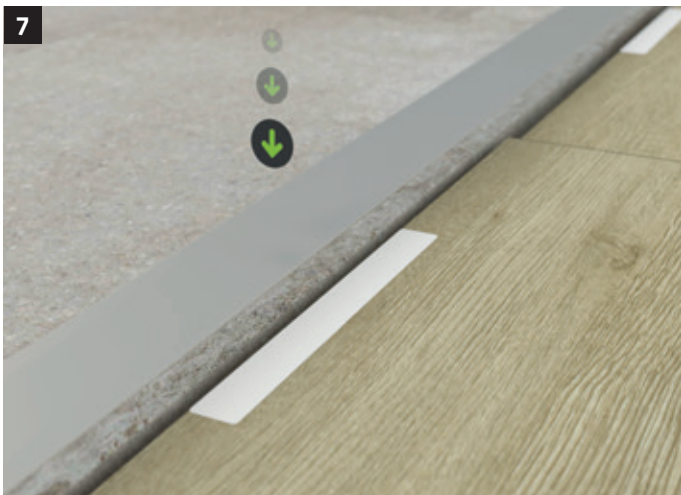

Stick the adhesive strips onto the floor covering every 30 cm according to point 5. Before installing the transition profiles, pull the yellow wax foil of the adhesive strips upwards at the tab.



The transition profile is installed. After a brief inspection, the next section can be assembled.

minileiste®

www.minileiste.com



Dealer stamp

minileiste by ENGELTECH GmbH
Nockhofweg 26h
6162 Mutters
Austria

+43 (0) 512 319 062
info@minileiste.com
www.minileiste.com



reddot winner 2020
best of the best



reddot winner 2020
best innovative product